

DATA SHEET

Accessories: Test cage PK 2000A

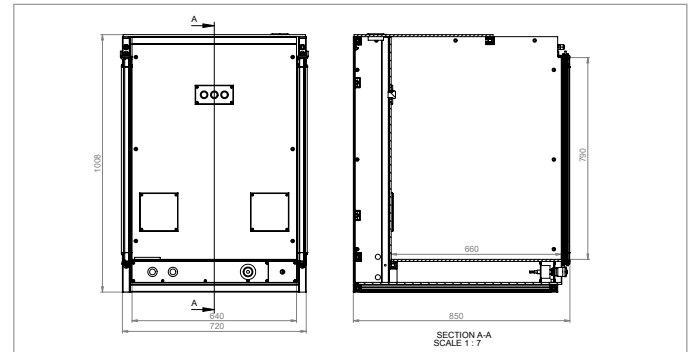

Test cage PK 2000A with light curtain

| | | |
|--------------------|---|--|
| Description | For test station setups in which a necessary protection against contact is required, test cages are particularly well suited. Through the light curtain the DUT cannot be touched during the generation of dangerous voltages. Once the light curtain is interrupted there is a forced switch-off. Due to the simple and comfortable handling test cages with light curtain are particularly well suited for testing large quantities. | |
| PK 2000A | <ul style="list-style-type: none"> • Setup made of aluminium profile 30 x 30 mm (1.2 x 1.2 in.) • Fully insulated test room made of PVC (colour: RAL 7011), casing made of Pertinax (colour: RAL 7035) • Safety light curtain with finger protection, 14 mm (0.6 in.) (type 4, FIL3, PLc) • Optional: mobile base with device compartment 19" / 14 HU • External dimensions (HxWxD): 1,008 x 720 x 850 mm (39.7 x 28.3 x 33.5 in.) • Internal dimensions (HxWxD): 790 x 640 x 660 mm (31.1 x 25.2 x 26.0 in.) | |
| Variants | Simple test hoods | For simple tests of small quantities test hoods with swivelling acrylic glass hoods are offered. These are available with or without device compartment to integrate a test device. In addition, depending on the application, different connection sets are available. |
| | Tandem test hood | For large quantities so-called tandem test hoods are also a good solution. Here two equal test areas are available. While it is tested in one test area, the other one can be loaded or unloaded at the same time. In a similar test and handling time the result is an optimum utilization of human and machine. Tandem test hoods can be equipped with swivelling acrylic glass hoods, movable test hoods or also with safety light curtain. |
| | Test cage with trapdoor | Test cages with trapdoor are mainly used when ergonomically a high number of DUT with a high weight is to be tested. The trapdoor is pneumatically moved, therefore the operator merely has to press a button, not move any mechanics. |

Versions

| Design types | Specialty | Max. dimensions of DUT (HxWxD) in mm (in.) | Type |
|------------------------------|--|--|----------|
| Simple test hood | Device compartment 19" / 5 HU | 180 x 410 x 350 (7.1 x 16.1 x 13.8) | HB 2100A |
| Simple test hood | Standard | 200 x 500 x 350 (7.9 x 19.7 x 13.8) | HB 3400A |
| Extra wide test hood | Device compartment 19" / 5 HU | 350 x 580 x 700 (13.8 x 22.8 x 27.6) | HB 5000A |
| Extra wide test hood | Double width, device compartment 2 x 19" / 4 HU | 300 x 700 x 400 (11.8 x 27.6 x 15.7) | HB 6000A |
| Extra wide test hood | Double width, device compartment 2 x 19" / 5 HU | 300 x 1,200 x 400 (11.8 x 47.2 x 15.7) | HB 7000A |
| Tandem test hood | Sliding hood, device compartment 2 x 19" / 3 HU | 400 x 568 x 580 (15.7 x 22.4 x 22.8) | TK 6000A |
| Tandem test hood | Sliding hood | 450 x 500 x 680 (17.7 x 19.7 x 26.8) | TK 7000A |
| Test cage with trapdoor | Trapdoor | 755 x 800 x 640 (29.7 x 31.5 x 25.2) | FK 1000A |
| Test cage with light curtain | Light curtain on one side | 790 x 640 x 660 (31.1 x 25.2 x 26.0) | PK 2000A |
| Test cage with light curtain | Double width, displaced foot space | 940 x 1,890 x 975 (37.0 x 74.4 x 38.4) | PK 6000A |
| Test cage with light curtain | Device compartment 19" / 16 HU, displaced foot space | 945 x 1,010 x 800 (37.2 x 39.8 x 31.5) | PK 7000A |